

# PETOL™ BUKUP TONG™ - BA115H Parts List

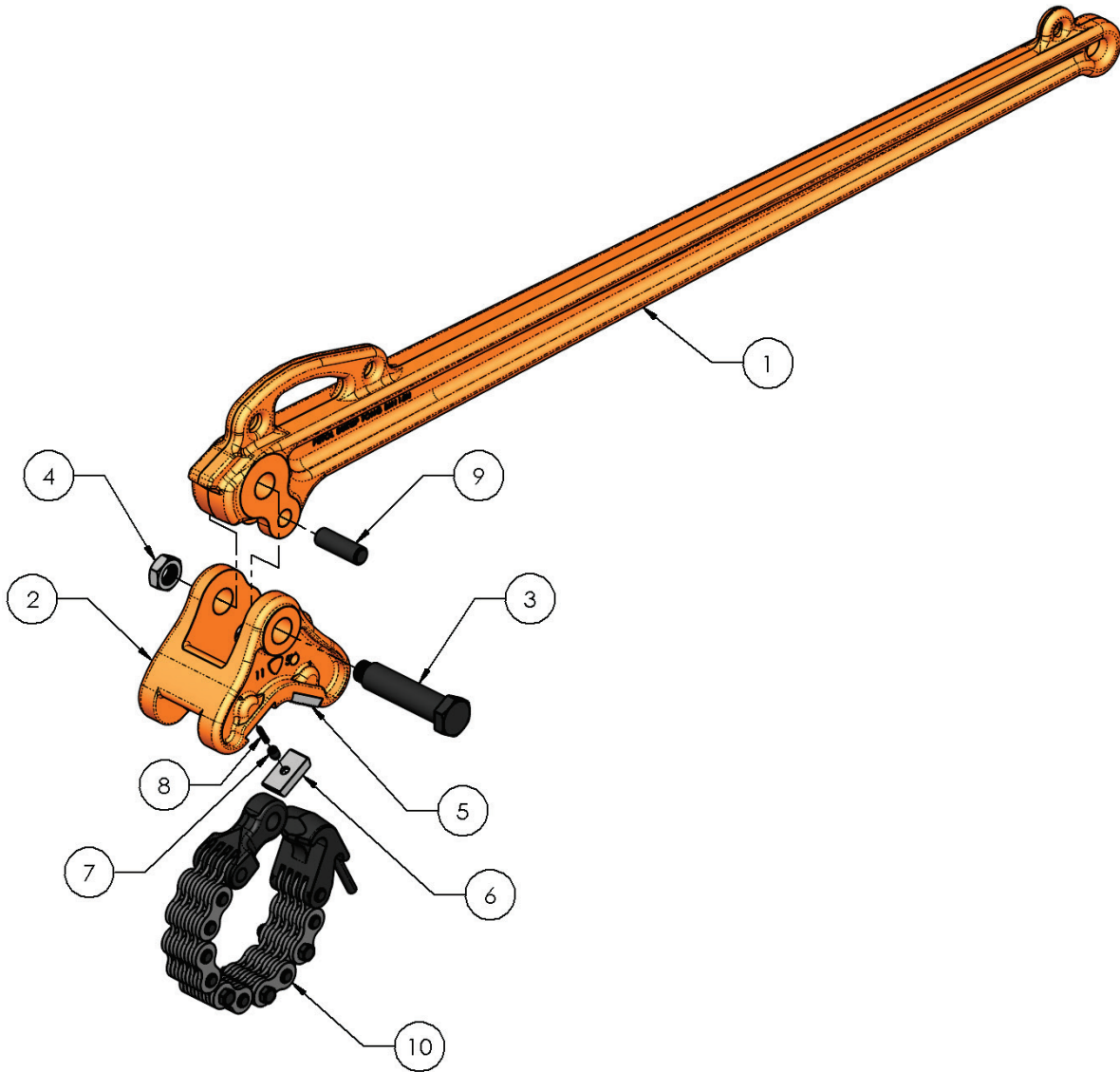

Item	Qty.	Part Number	Description
1	1	BH115H	Handle
2	1	BJ115H	Jaw
3	1	HB08	Jaw-handle bolt with nut
4	1	HXN004	Jaw-handle nut only
5	2	HI08D	Diamond point insert (standard)
5	2	HI08K	Knurled insert (optional)
6	2	HI08B	Blank insert (standard)
7	4	HP902	Insert key
8	4	HS20SS	Insert key spring
9	1	HP235	Master link – handle pin
10	1	*	Chain assembly (see next page for parts)

\*See Chain Guide on product web page



4450 S. Hwy. 6 | P.O. Box 192  
Clifton, TX 76634 | USA  
[www.PETOL.com](http://www.PETOL.com)

[sales@petol.com](mailto:sales@petol.com) | 254.675.8651

# PETOL™ BUKUP TONG™ - BA115H Parts List

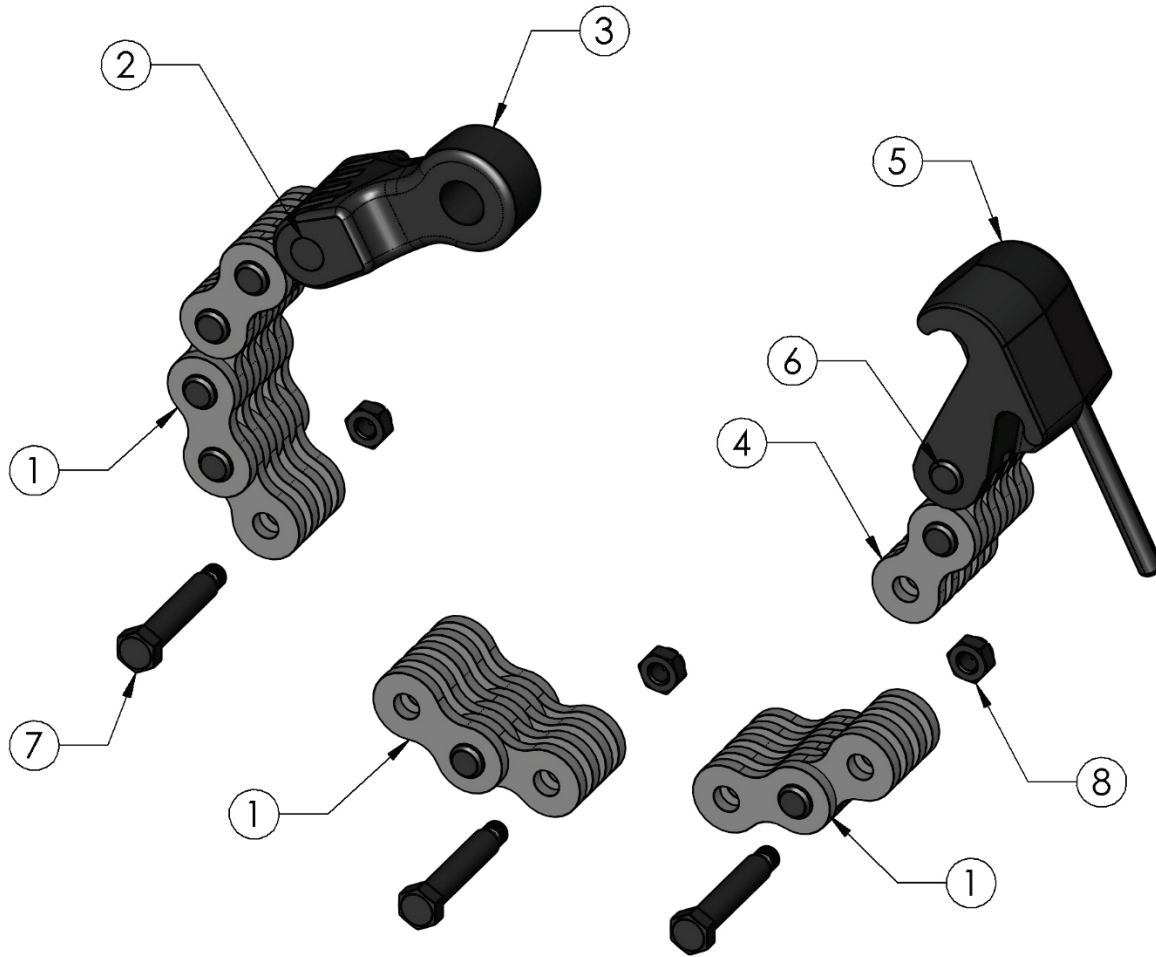

Item	Part No.	Description
1	151-45-02	Special chain only
1	151-45-04	Special chain only
1	151-45-05	Special chain only
2	HP237	Master link – chain rivet
3	HM01-45	Master link
4	151-45-02-2625	Chain hook assembly
4	151-45-02-3625	Chain hook assembly
4	151-45-02-4250	Chain hook assembly
5	HC05-45-2625	Chain hook only
5	HC05-45-3625	Chain hook only
5	HC05-45-4250	Chain hook only
6	HP236	Chain hook rivet
7	HB48	Splice bolt with nut
8	HXN015	Splice bolt nut only



4450 S. Hwy. 6 | P.O. Box 192  
 Clifton, TX 76634 | USA  
[www.PETOL.com](http://www.PETOL.com)

[sales@petol.com](mailto:sales@petol.com) | 254.675.8651