

# **PETOL™ Bukup Tong**

## **BA120**

### **Operating Manual**



**PETOL™ GEARENCH**

**P.O. Box 192**

**4450 Highway 6**

**Clifton, Texas 76634**

**Phone: (254) 675-8651**

**Fax: (254) 675-6100**

© 2021 by PETOL GEARENCH. All rights reserved

Form BA120 revision 05/10/2021

## Table of Contents

<b>BA120 PETOL™ Bukup Tong Description .....</b>	<b>1</b>
<b>PETOL™ GEARENCH Limited Warranty .....</b>	<b>2</b>
<b>Safe Practices and Procedures .....</b>	<b>3</b>
Responsibility .....	3
Replacement Parts .....	4
Safety .....	4
Safe Practices .....	4
Safety Sources and Publications .....	5
Responsibility of Distributors .....	5
Overloading / Shock Loads / Side Loading .....	6
Environmental Conditions .....	6
Normal Life Expectancy .....	7
Lubrication .....	7
Periodic Inspection List for PETOL™ Special Chain .....	8
<b>Operation .....</b>	<b>10</b>
<b>Chain Identification Guide .....</b>	<b>11</b>
<b>Chain Selection .....</b>	<b>12</b>
<b>Dimensions .....</b>	<b>13</b>
<b>Torque and Diameter Capacity .....</b>	<b>14</b>
<b>Torque – Handle Load Formulas – Short Torque Arm Length .....</b>	<b>15</b>
<b>Torque – Handle Load Formulas – Long Torque Arm Length .....</b>	<b>15</b>
<b>Parts List .....</b>	<b>16</b>
Tong Assembly Parts List .....	16
Chain Assembly Parts List .....	18
<b>Wear Limits .....</b>	<b>19</b>
<b>Non-Destructive Evaluation .....</b>	<b>20</b>
<b>Weld Repairs .....</b>	<b>21</b>

## **BA120 PETOL™ Bukup Tong Description**

The PETOL™ Bukup Tongs were designed for making up and breaking out casing, drill pipe, and tubular products requiring substantial torque while the pipe is essentially horizontal. The BA120 PETOL Bukup Tong will work diameters from 6 inches to 22 inches and up to 151,900 foot-pounds of torque.

The tong is adjusted by exchanging chain sections and chain hooks to work the various diameters.

The BA120 Bukup Tong has the following features:

- A high strength, heat treated alloy chain for rugged, dependable service.

- High strength alloy steels used throughout for long life with the toughest jobs.

# **PETOL™ GEARENCH Limited Warranty**

## **What Is Covered**

PETOL™ GEARENCH tools are expressly warranted to you, the purchaser, to be free of defects in material and workmanship.

## **How Long Coverage Lasts**

This express warranty lasts for the lifetime of the PETOL GEARENCH tool. Warranty coverage ends when the tool becomes unusable for reasons other than defects in workmanship or material.

## **How Can You Get Warranty Service**

To obtain the benefit of this warranty, contact a PETOL GEARENCH sales representative in Clifton, Texas.

PETOL GEARENCH · 4450 S. Highway 6 · P.O. Box 192 · Clifton, TX 76634

## **What Will We Do To Correct Problems**

Warranted products will be repaired or replaced, at PETOL GEARENCH's option, and returned at no charge to you, the original purchaser; or, if after three attempts at repair or replacement during the warranty period, the product defect in material or workmanship persists, you can elect to receive a full refund of your original purchase price for the product.

## **What Is Not Covered**

Defects, failures or conditions that are due to normal wear and tear, abuse or misuse, are not covered by this limited warranty. In addition, this limited warranty is in lieu of all other warranties, express or implied, verbal or written. To the maximum extent allowed by law PETOL GEARENCH disclaims all implied warranties, including implied warranties of merchantability and/or fitness for a particular purpose. PETOL GEARENCH also specifically denies any liability for any incidental damages and/or consequential damages, including but not limited to property damage to property other than the product itself, loss of sales profits, down time, costs or any other damages measurable in money, whether or not included in the foregoing enumeration.

Please be advised that some states do not allow the exclusion or limitation of incidental or consequential damages, so this limitation or exclusion may not apply to you. This warranty gives you specific rights, and you may also have other rights, which vary from state to state, province to province, or country to country.

## **Are Personal Injuries Covered**

In the event you, someone working for you, or any other person sustain a personal injury as a result of using the PETOL GEARENCH tool, PETOL GEARENCH limits its potential liability for such a claim or injury to the fullest extent allowed by law, and disclaims and denies any liability for such personal injury.

Please be advised that some states do not allow the exclusion or limitation of liability for personal injuries, so the above limitation or exclusion may not apply to you, or the individual claiming injury.

## **No Other Express Warranty Applies**

This PETOL GEARENCH LIMITED WARRANTY is the sole and exclusive warranty, express or implied for PETOL GEARENCH products. No employee, agent, dealer or other person is authorized to alter, modify, expand or reduce the terms of this warranty or to make any other warranty on behalf of PETOL GEARENCH.

## **Law Applicable**

All matters related to the sale and/or use of the PETOL GEARENCH tool that is the subject of this limited warranty, along with the construction and enforcement of the terms of this limited warranty itself, shall be subject to the substantive and procedural laws of the state of Texas, not the conflicts of laws provisions of Texas, but rather the laws of Texas themselves.

**Forum Selection Clause**

Any dispute arising out of the sale and/or use of the PETOL GEARENCH tool that is the subject of this limited warranty shall be presented in the form of a claim or lawsuit to the offices of PETOL GEARENCH in Clifton, Bosque County, Texas. No claim or suit may be brought against PETOL GEARENCH, arising out of the sale and/or use of the tool, or arising out of the terms of this warranty, except in such forum. Purchase and/or use of the PETOL GEARENCH tool makes you subject to the benefits and limitations of this limited warranty. Accordingly, any writ, judgment or other enforcement, obtained from a jurisdiction, county, parish, state or federal court or other country, other than from the forum identified above, shall be void and unenforceable against PETOL GEARENCH.

**Arbitration Clause**

In the event of dispute or claim arises out of the sale and/or use of the PETOL GEARENCH tool that is the subject of this limited warranty, or arises out of the interpretation or enforcement of the terms and conditions of this limited warranty, such dispute shall be submitted to binding arbitration pursuant to the rules of the American Arbitration Association. If required to accomplish the purpose of this Arbitration clause, the purchaser hereby expressly waives any right to demand trial by jury.

**Complete Agreement**

This express limited warranty contains the entire agreement regarding express or implied warranties related to the PETOL GEARENCH tool that is the subject of it. No writing or language contained in the purchase order or any other document of the purchaser, or invoice of PETOL GEARENCH or any intermediate seller, shall be construed as modifying, in any way, the rights and liabilities contained in this limited warranty. PETOL GEARENCH expressly disclaims any obligations expressed in any customer purchase order or document that are contrary to the terms and limitations of this warranty.

**Severability**

If any term or limitation contained in this limited warranty is deemed unenforceable by law, then the term shall be severed from the remaining portions of the limited warranty which shall remain enforceable.

All communications to PETOL GEARENCH regarding the use of the tool and any aspect of the sale of the tool of this limited warranty should be addressed to PETOL GEARENCH.

PETOL GEARENCH · 4450 S. Highway 6 · P.O. Box 192 · Clifton, TX 76634

**Safe Practices and Procedures****Responsibility**

"It is the responsibility of the employer to train the employee in the proper selection and usage of tools, chains, etc., and to ensure that they are selected and used in that manner. In many instances, injury results because it is assumed that anybody knows how to use common hand tools. Observations and the record show that this is not the case. A part of every job instruction program should therefore be detailed training in the proper use of hand tools (and of all other special tools and equipment needed to accomplish the job)." - (Source: National Safety Council)

"Employers are responsible for the safe condition of tools and equipment used by employees, including tools and equipment which may be furnished by employees." - (Source: OSHA 1910.242A)

## **Replacement Parts**

Use only PETOL™ replacement parts - no other parts are of comparable strength, quality and interchangeability.

## **Safety**

While we pride ourselves on the quality and dependability that we build into PETOL GEARENCH tools and products, we caution users that it is only prudent to know and follow the simple rules of safety when using our products, or anyone else's.

Always follow safe practices and procedures in accordance with the recommendations of OSHA, The National Safety Council (NSC), The Hand Tools Institute (HTI), The International Association of Drilling Contractors (IADC), Etc. All applicable Governmental rules, regulations or restrictions, now in effect or which may be promulgated, take precedence over the suggestions in this publication. The information in this publication is designed to supplement standard safe practices and procedures, not in lieu of, or replacement thereof.

## **Safe Practices**

### **(Source: The National Safety Council)**

Failure to observe one or more of the following five safe practices accounts for most hand and powered tool accidents:

1. ALWAYS WEAR SAFETY GOGGLES TO PROTECT EYES
2. SELECT THE RIGHT TOOL FOR THE JOB
3. KEEP TOOLS IN GOOD CONDITION
4. USE TOOLS CORRECTLY
5. KEEP TOOLS IN A SAFE PLACE

Safety Goggles must always be worn by persons in any area where hand and powered tools are being used.

Never apply excess leverage to a wrench or tool by means of a "Cheater Bar". Never strike wrenches and tools with hammers or other objects.

All tools should be kept clean, inspected on a regular basis, and replaced when they show signs of wear.

Be especially careful not to place yourself in a position that could result in bodily injury in the event of a failure. Brace yourself firmly and pull rather than push when wrenching. (If necessary, to push, do so with the flat of the hand rather than gripping around the wrench.)

Never stand under or near loads being hoisted off the ground.

READ SAFE PRACTICES AND PROCEDURES MANUAL, CATALOG INFORMATION AND PRODUCT LABELING PRIOR TO OPERATION.

## **Safety Sources and Publications**

In the interest of Safety the following sources of Safety information is furnished:

The Hand Tools Institute (HTI)  
25 North Broadway  
Tarrytown, New York 10591  
(914) 332-0040  
[www.hti.org](http://www.hti.org)

The National Safety Council (NSC)  
1121 Spring Lake Drive  
Itasca, Illinois 60143-3201  
(630) 285-1121  
[www.nsc.org](http://www.nsc.org)

International Safety Council  
1121 Spring Lake Drive  
Itasca, Illinois 60143-3201  
(630) 285-1121

## **Responsibility of Distributors**

IT IS THE RESPONSIBILITY OF THE PURCHASERS OF PETOL™ GEARENCH PRODUCTS TO CONVEY THE INFORMATION IN THIS PUBLICATION AND ANY OTHER INFORMATION RELATING TO THE INDIVIDUAL PRODUCT, THROUGH THE CHANNELS OF DISTRIBUTION, DOWN TO AND INCLUDING THE INDIVIDUAL USING THE PRODUCT

### **NOTE:**

**In view of the fact that the actual use determines whether safety requirements have been met, the ultimate responsibility to comply rests with the end user.**

The service life of leaf chains can be altered by a variety of adverse operating conditions. The following information discusses the most important of these conditions for consideration when operating or scheduling replacement of leaf chain systems.

## **Overloading / Shock Loads / Side Loading**

Attempting to “inch loads which are beyond the rated capacity of the tool.

Striking the tool with a hammer or other object while force is being exerted in an attempt to loosen a “frozen” joint.

Side pull can be caused by pulling or pushing on the tong in a direction that is not along a perpendicular plane, unlevelled mounting of the tong or vise, inadequate support of the part being broken out, and improper seating of the part being broken out in the tong or vise. Improper seating will occur when the diameter of the part is not consistent within the width of the tong or vise jaw.

## **Environmental Conditions**

Wrench chains operate in widely varying environments, from wet outdoor conditions to mildly or highly corrosive industrial atmospheres. They can also be exposed to abrasives such as sand or grit.

The possible effects include:

Moisture - Corrosion and rust reduce chain strength by causing pitting and cracking.

Temperature - Very cold temperatures reduce chain strength by embrittlement.

Chemical Solutions or Vapors - Corrosive attack of the chain components' grain structure and/or the mechanical connections between the chain components (crevice corrosion) may occur. Cracking often is microscopic. Propagation to complete failure can be eventual or sudden.

Abrasives - Accelerated wearing and scoring of the articulating chain members (pins and plates) may occur, with a corresponding reduction in chain strength. Due to inaccessibility of the bearing surfaces (pin surfaces and plate apertures), wear and scoring are not readily noticeable.

These conditions, when coupled with normal chain wear and inherent residual stress (normally in the chain as constructed), can result in environmentally assisted failure. It is impossible to predict chain life under complex conditions, as the degree of hostility and its effects are dependent on many variables such as temperature, time of exposure, concentration of corrosive atmosphere or medium, degree of abrasive wear, etc. Establishing the degree and frequency of unpredictable dynamic loading is also difficult.



## **Normal Life Expectancy**

A leaf chain's normal life expectancy can be expressed as a maximum percent of elongation. This is generally between 2% and 3% of pitch. As the chain flexes back and forth, the bearing joints (pins and inside link plates) gradually wear from articulation. As with all steel bearing surfaces, the precision hardened steel joints of leaf chain require a constant film of oil between mating parts to prevent wear and to resist corrosion.

## **Lubrication**

One of the most important but often overlooked factors is adequate lubrication. In addition to reducing internal friction, maintaining a film of oil on all chain surfaces will inhibit rusting and corrosion, this is important as corrosion of highly stressed, hardened steel chain components can cause a major reduction in the load capacity of leaf chain and result in link plate cracking.

Protection from corrosion is important in storage as well as in service. The factory lubricant applied to PETOL™ Chain is a "Fingerprint Neutralizing Water-Displacing Corrosion Preventative." This is an excellent rust and corrosion inhibitor for chains in storage.

Do not attempt to paint chains. Though painting may help inhibit corrosion, it will seal off critical clearances and restricts oil from reaching the pin surfaces where it is needed for good joint lubrication. Do not plate chains or chain components. Highly stressed alloy steel components are subject to hydrogen embrittlement caused by plating. Periodic relubrication of chains is the most important factor in extending the life of the chains. There is no lubricant that is ideal for all situations.

A heavy oil lubricant provides excellent protection during prolonged storage, but is messy to apply, will attract dirt and other contaminants and is messy to use. These contaminants could lead to premature abrasive wear of the moving components. When operating in dusty environments, lubricated chains will accumulate a paste like buildup of grime. At periodic intervals, this buildup should be removed by cleaning and the chain should be immediately relubricated. Do not use caustic or acid type cleaners; use a stiff brush and a certified safe petroleum base solvent.



Light oil-based lubricants penetrate into articulated joints easily but can also be washed off or rubbed off during use. A light oil-based lubricant must have periodic reapplication of the lubricant to maintain coverage.

Specialty chain lubricants (wax-based) provide excellent lubrication. They have no oily residue. They are easy to apply. They can be more expensive than other lubricants and are subject to being washed off or worn off. Wax-based lubricants must have periodic reapplication of the lubricant to maintain coverage.

The frequency of relubrication is the most important factor. It will depend on frequency of use, length of storage between uses, exposure to dust and other contaminants, and exposure to salt water or other corrosion accelerants. The end user should establish a good preventative maintenance program for relubrication of all chains and articulated components.

## Periodic Inspection List for PETOL™ Special Chain

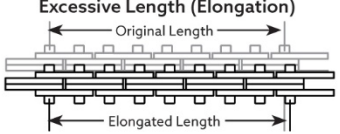
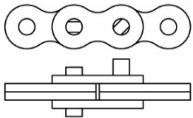
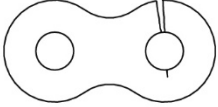
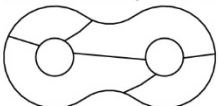
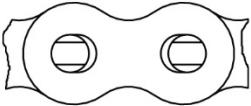
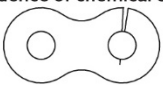
1. Prior to each use, Leaf Chain and tools should be inspected for serviceability and lubrication.
2. Use Only PETOL™ Replacement Parts - No other parts are of comparable strength, quality, and interchangeability.

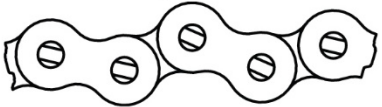
APPEARANCE AND/OR SYMPTOM	PROBABLE CAUSE	CORRECTION
<b>Excessive Length (Elongation)</b> 	Normal Wear Permanent deformation (stretch) from overload	Replace chain Replace chain and correct cause of overload
<b>Abnormal Protrusion of Pins</b> 	Overloading Inadequate lubrication Side Loading	Replace chain and correct cause of overload Replace chain and improve lubrication Replace chain and correct cause of side load
<b>Cracked Plates (Fatigue)</b> 	Overloading Side Loading	Replace chain and correct cause of overload Replace chain and correct cause of side load
<b>Arc-Like Cracked Plates (Stress Corrosion)</b> 	Severe rusting or exposure to acidic or caustic medium, plus static stress at press fit between pin and plate.	Replace chain and protect from hostile environment
<b>Enlarged Holes</b> 	Overloading	Replace chain and correct cause of overload
<b>Cracked Plates (Corrosion Fatigue)</b> Perpendicular to Pitch Line, plus rust or other evidence of chemical corrosion 	Corrosive Environment	Replace chain and protect from hostile environment
<b>Fractured Plates (Tension Mode)</b> 	Overloading	Replace chain and correct cause of overload
<b>Tight Joints</b> 	Dirt or foreign substance packed in joints Corrosion and rust Bent Pins	Clean and relube Replace chain and protect from hostile environment Replace chain

## **Safety Precautions**

1. Always wear safety goggles to protect eyes.
2. Select the right tool for the job.
3. Keep tools in good condition.
4. Use tools correctly.
5. Keep tools in a safe place.
6. Wear protective clothing, gloves and safety shoes as appropriate.
7. Use lengths of assembled chain. Do not build lengths from individual components.
8. Do not attempt to rework damaged chain by replacing only the components obviously faulty. The entire chain may be compromised and should be discarded.
9. Never electroplate assembled leaf chains or components. Plating will result in failure from hydrogen embrittlement.
10. Do not weld any chain or component. Welding spatter should never be allowed to come into contact with chain or components.
11. Leaf chains are manufactured exclusively from heat-treated steels and therefore must not be annealed. If heating a chain with a cutting torch is absolutely necessary for removal, the chain must not be reused.
12. Inspect chains frequently and regularly for link plate cracking, pin turning, pin protrusion and corrosion.
13. Use only PETOL replacement parts to ensure proper strength.

## Operation

The typical application of one Bukup Tong is shown in the figure below. Normally backup will be provided by an additional tong or by a vise. The backup tong or vise is not shown for clarity. The tong will exert torque when the line is pulled as shown below. The tong will ratchet when the tong is moved in the opposite direction. Ratcheting is used when the tong must be pulled more than once to completely makeup or breakout the connection.

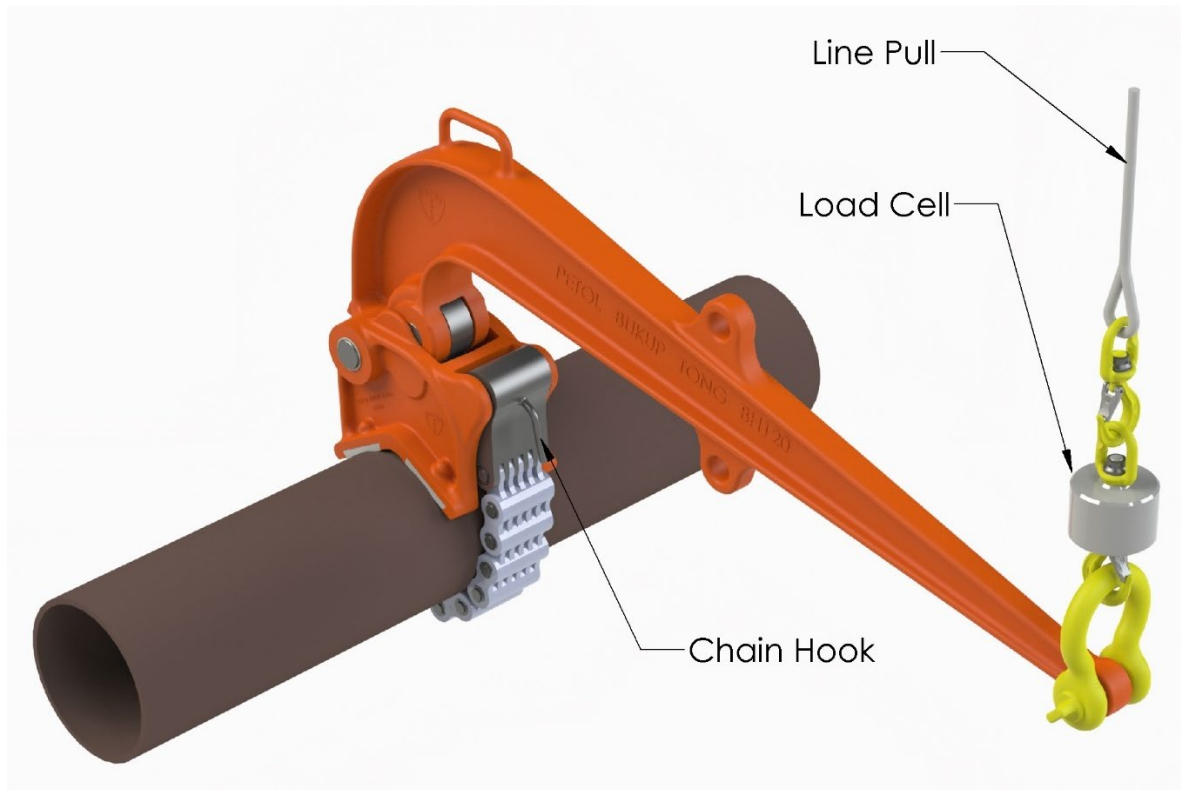

**WARNING:** The pipe must be constrained to prevent excessive deflection of the pipe. Excessive deflection of the pipe could lead to side loading. Side loading will result in premature failure of the tong and/or chain which may result in injury or death.

**WARNING:** Do not actuate the tong with an overhead bridge crane unless the crane is guarded from derailing. Sudden release of energy, such as when a connection is broken loose, can cause an overhead bridge crane to spring upwards resulting in the crane derailing. Derailing of an overhead crane may result in the crane falling to the floor resulting in injury or death.

## Chain Identification Guide

2 LINK SECTION

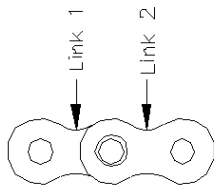

5 LINK SECTION

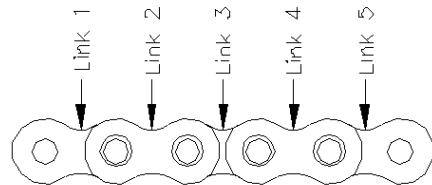

CHAIN ASSEMBLY

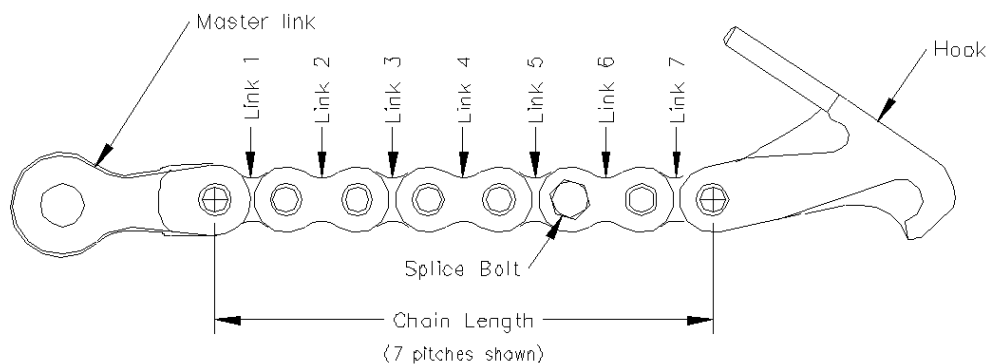

THIS IS WHAT A CHAIN PART NUMBER TELLS YOU

161-45-07L4500			
Chain Size		Hook Length	
151	Chain Combination	Tong Type	
161		B=Bukup Tong	
181		D=Drill Pipe Tong	
201		D7=Drill Pipe Tong (DA6184 only)	
		F=Friction Tong	
		L=Bull Tong	
		M=Machine Tong	
		T=Tongvise/Visetong	
		Chain Length (pitches)	
		(see above)	

## Chain Selection

The following table lists the diameter range of all chain assemblies used with this tong.

Chain	Min Dia. (inches)	Max Dia. (inches)
201-56-09B6000	6	6-7/8
201-56-09B7750	6-5/8	7-1/2
201-56-09B9875	7-3/8	8-1/4
201-56-11B6000	8	8-7/8
201-56-11B7750	8-5/8	9-1/2
201-56-11B9875	9-3/8	10-1/4
201-56-13B6000	10	10-7/8
201-56-13B7750	10-5/8	11-1/2
201-56-13B9875	11-3/8	12-1/4
201-56-15B6000	12	12-7/8
201-56-15B7750	12-5/8	13-1/2
201-56-15B9875	13-3/8	14-1/8
201-56-17B6000	14	14-7/8
201-56-17B7750	14-5/8	15-3/8
201-56-17B9875	15-3/8	16
201-56-19B6000	16	16-3/4
201-56-19B7750	16-1/2	17-1/4
201-56-19B9875	17-1/4	17-7/8
201-56-21B6000	17-7/8	18-5/8
201-56-21B7750	18-1/2	19-1/4
201-56-21B9875	19-1/8	19-7/8
201-56-23B6000	19-3/4	20-1/2
201-56-23B7750	20-3/8	21-1/8
201-56-23B9875	21	22

Dimensions

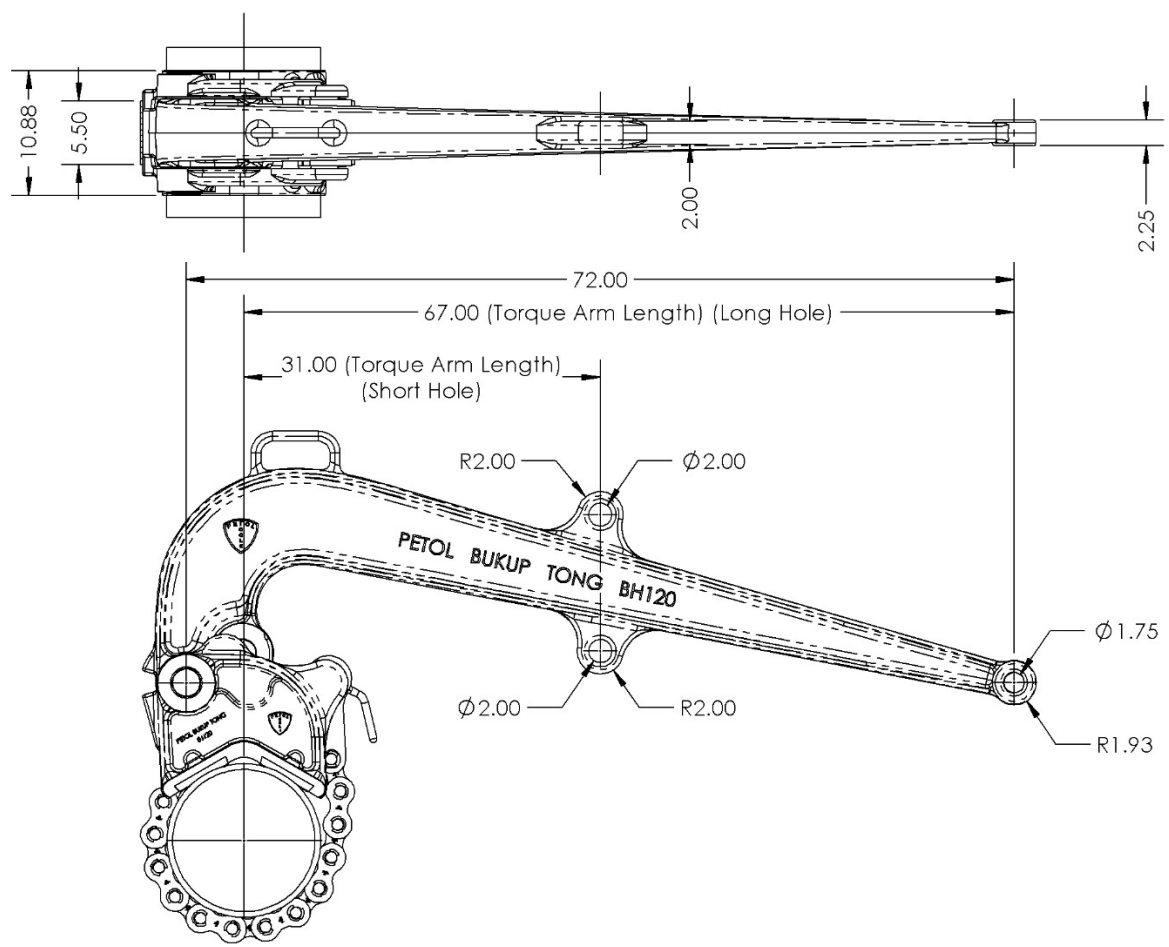

## Torque and Diameter Capacity

The following table lists the maximum working torques and the corresponding handle loads for the diameter range of the tong.

Diameter	Short Torque Arm Length			Long Torque Arm Length		
	Torque Arm Length (inches)	Maximum Torque (foot-pounds)	Maximum Line Pull (pounds)	Torque Arm Length (inches)	Maximum Torque (foot-pounds)	Maximum Line Pull (pounds)
6	31.00	136,900	53,000	67.00	148,000	26,500
7	31.00	139,000	53,800	67.00	150,200	26,900
8	31.00	140,500	54,400	67.00	151,900	27,200
9	31.00	140,500	54,400	67.00	151,900	27,200
10	31.00	140,500	54,400	67.00	151,900	27,200
11	31.00	140,500	54,400	67.00	151,900	27,200
12	31.00	140,500	54,400	67.00	151,900	27,200
13	31.00	140,500	54,400	67.00	151,900	27,200
14	31.00	140,500	54,400	67.00	151,900	27,200
15	31.00	140,500	54,400	67.00	151,900	27,200
16	31.00	140,500	54,400	67.00	151,900	27,200
17	31.00	140,500	54,400	67.00	151,900	27,200
18	31.00	140,500	54,400	67.00	151,900	27,200
19	31.00	140,500	54,400	67.00	151,900	27,200
20	31.00	140,500	54,400	67.00	151,900	27,200
21	31.00	140,500	54,400	67.00	151,900	27,200
22	31.00	140,500	54,400	67.00	151,900	27,200

**WARNING:** Under no circumstances should the maximum working load be exceeded. Overloading may result in injury or death. Always use a load cell or other calibrated indicating device to monitor the line pull on the tong to avoid an overload.



## **Torque – Handle Load Formulas – Short Torque Arm Length**

The following formula is used to determine the handle force required to produce a known torque for the short torque arm:

$$\mathbf{F = T / 2.5833}$$

Where F is the handle force in pounds and, T is the desired torque in foot-pounds. To find the torque produced from an observed handle force for the short torque arm length, use the following formula:

$$\mathbf{T = F * 2.5833}$$

Where F is the handle force in pounds and, T is the produced torque in foot-pounds.

## **Torque – Handle Load Formulas – Long Torque Arm Length**

The following formula is used to determine the handle force required to produce a known torque for the long torque arm:

$$\mathbf{F = T / 5.5833}$$

Where F is the handle force in pounds and, T is the desired torque in foot-pounds. To find the torque produced from an observed handle force for the long torque arm length, use the following formula:

$$\mathbf{T = F * 5.5833}$$

Where F is the handle force in pounds and, T is the produced torque in foot-pounds.

## Parts List

The following drawings, diagrams, and parts lists describe all parts, which may be needed as replacement items.

**All tong components are manufactured only by PETOL™ GEARENCH. DO NOT ATTEMPT TO SUBSTITUTE THESE COMPONENTS.** The tong will not work properly unless these components are matched to the specific application. Consult our factory as your requirements change. Any non-PETOL substitutions of these components void all warranties and subject the user to assumption of liabilities resulting from subsequent use.

### Tong Assembly Parts List

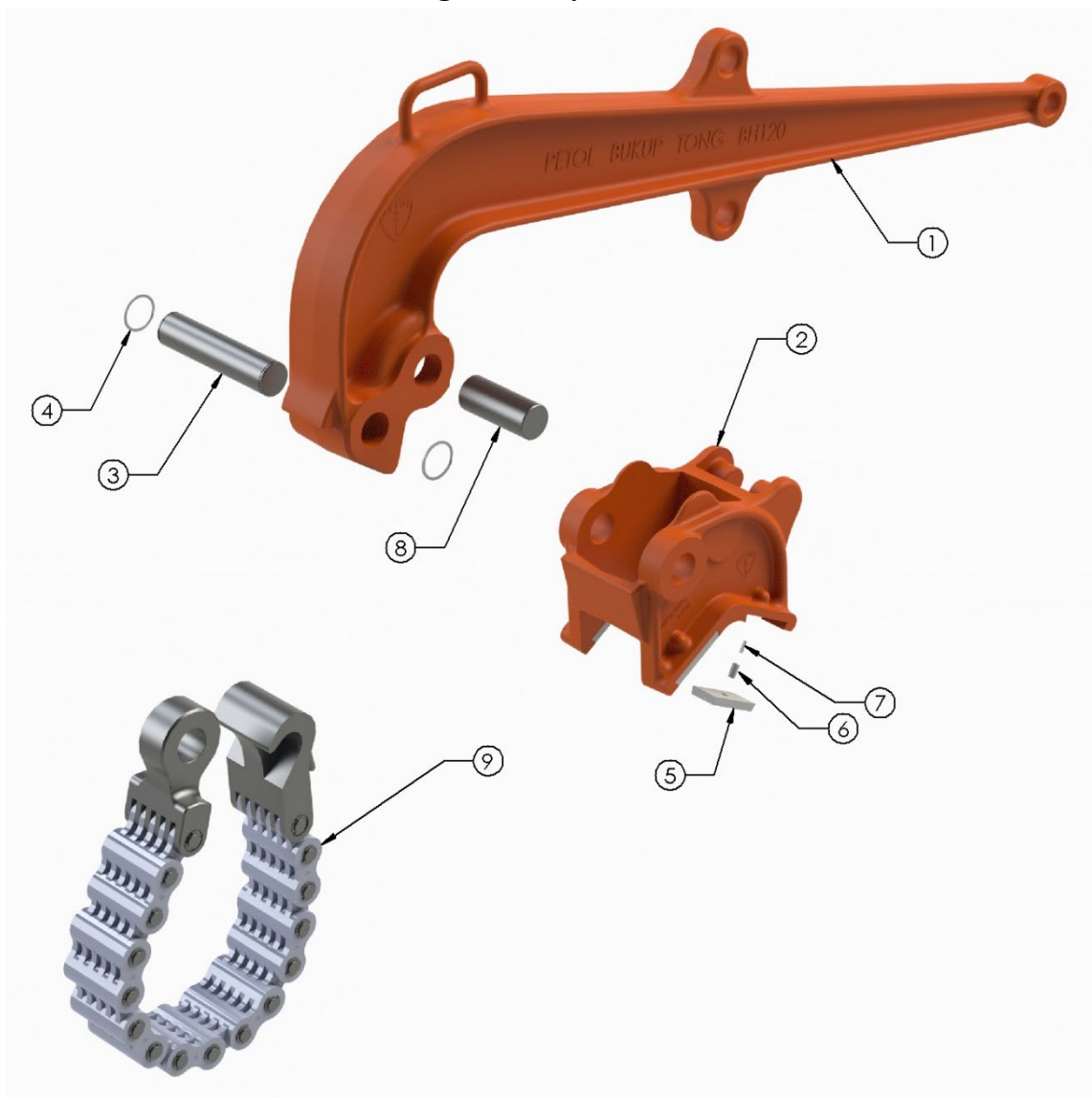

### Tong Assembly Parts List

Item	Qty.	Part Number	Description
1	1	BH120	Handle
2	1	BJ120	Jaw
3	1	HP019	Jaw-handle pin with retaining ring
4	1	HXRR250	Jaw-handle retaining ring only
5	4	HI10D	Diamond point insert (standard)
6	4	HP904	Insert key
7	4	HS21	Insert key spring
8	1	HP020	Master link – handle pin
9	1	See tables	Chain assembly

## Chain Assembly Parts List

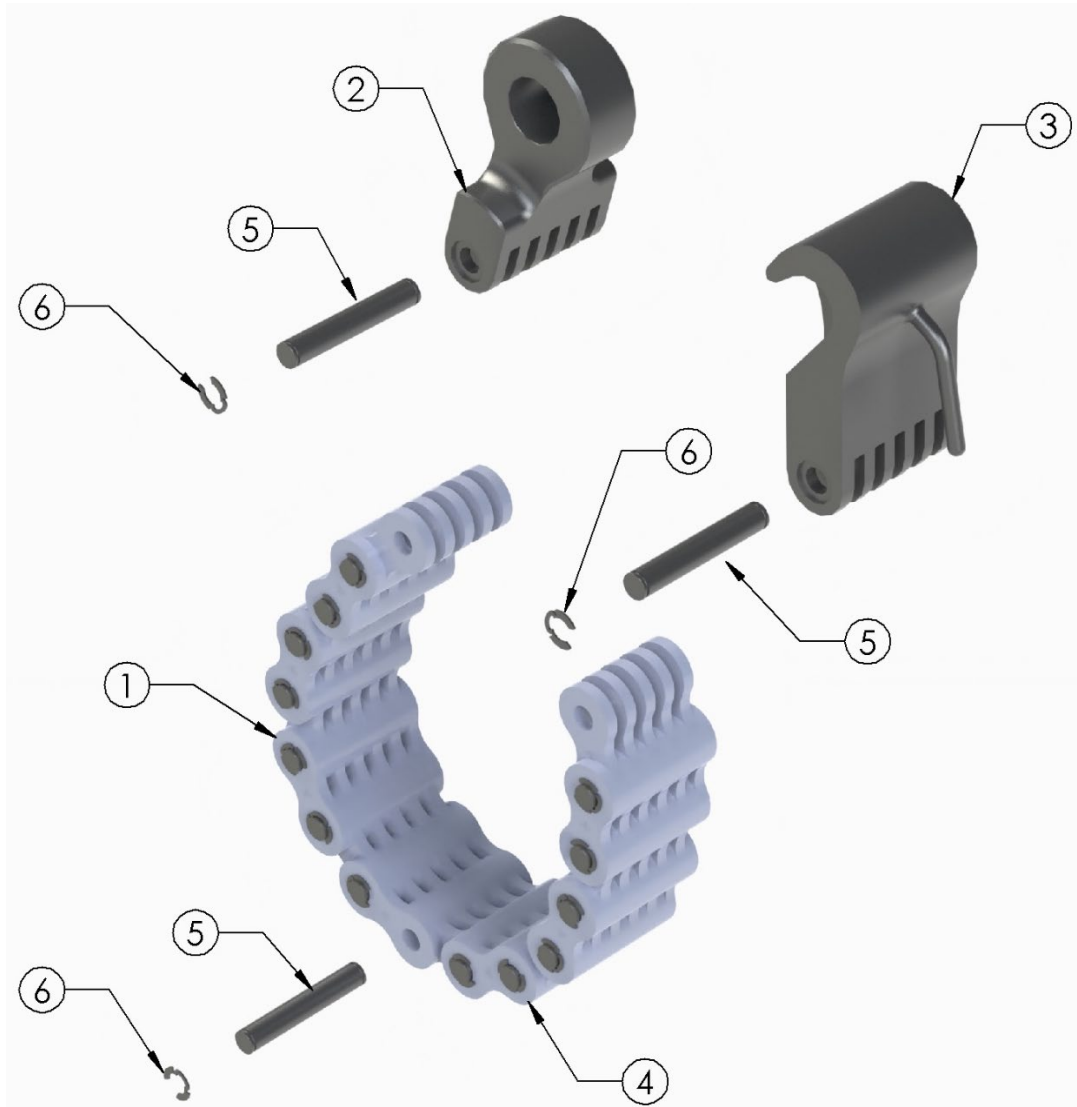

Item	Part No.	Description
1	201-56-02	Special chain only
1	201-56-03	Special chain only
1	201-56-05	Special chain only
1	201-56-07	Special chain only
2	HM09-56	Master link
3	HC07-56-6000	Chain hook
3	HC07-56-7750	Chain hook
3	HC07-56-9875	Chain hook
4	20-1-A	Chain link
5	HP328	Chain pin with kliprings
6	HXKR100	Chain pin klipring only

## Wear Limits

The following table indicates limiting diameters on the components of the PETOL™ Bukup Tong. When localized wear is beyond any one of the limits indicated, the component should be replaced.

Part Number	Description	Location	Limit diameter
HP019	Jaw – handle pin	Pin body	2.475 (min)
HP020	Master link – handle pin	Pin body	2.475 (min)
BH120	Handle	Jaw pin hole	2.520 (max)
BH120	Handle	Master link pin hole	2.520 (max)
BH120	Handle	Load loop (long)	1.850 (max)
BH120	Handle	Load Loop (short)	2.100 (max)
BJ120	Jaw	Handle pin hole	2.520 (max)
BJ120	Jaw	Chain screw nut lug	2.100 (max)
201-56-xxBxxxx	Chain assembly	Entire chain	See pages 8 & 9

## Non-Destructive Evaluation

The figures below indicate the critical areas of the tong handle and jaw. A critical area is defined as an area in which no unrepaired crack indications are permitted and in which no major weld repairs are permitted. There are no critical areas on the bar hanger. Weld repairs are only permitted on the handle, jaw, and bar hanger.

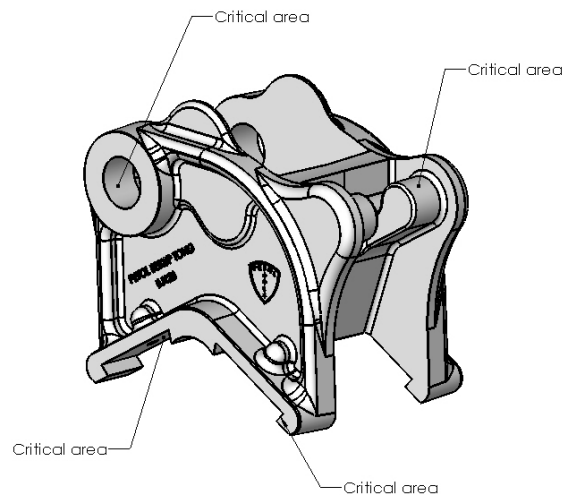
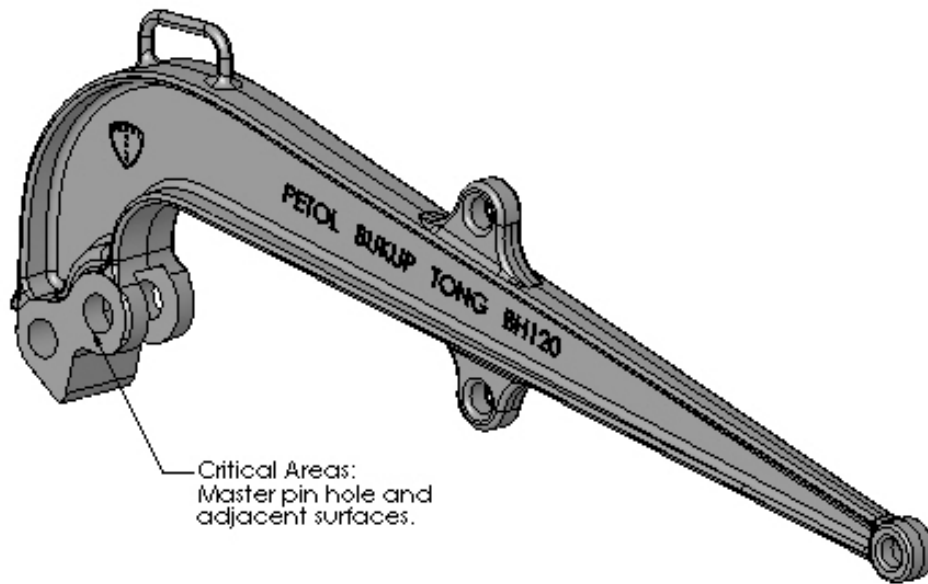

## **Weld Repairs**

### **Scope:**

This procedure is to be followed for minor repairs of crack indications in heat treated alloy steels. A weld repair shall be considered minor when the depth of the cavity does not exceed 30% of the actual wall thickness or 1 inch, whichever is smaller, or when the extent of the cavity does not exceed approximately 10 square inches. Major weld repairs must be performed by PETOL™ GEARENCH or an approved repair center using appropriate procedures followed by full heat treatment and load testing.

### **Application:**

This procedure applies to steel castings, forgings and, wrought with carbon content between 0.15% and 0.31%.

### **Weld preparation:**

The crack indication is to be removed by carbon arc gouging, grinding, or machining until all indication is removed. Magnetic particle inspection shall be used to verify that the crack indication has been removed.

### **Filler material and process:**

Repairs made with the FCAW process shall use a filler material of class E120T5-K4 or equivalent with CO<sub>2</sub> shielding gas. Repairs made with the SMAW process shall use a filler material of type E-12018-M. All welding is to be performed by a qualified welder.

### **Preheat:**

Preheat the weld area to 300°F minimum.

### **Interpass temperature:**

The interpass temperature is to be 600°F maximum. All weld slag to be removed prior to application of additional layers by chipping, grinding or wire brushing. Do not peen the weld repair.

### **Post weld heat treatment:**

Do not allow weld to cool below 300°F before stress relief. Post heat immediately after welding to 1010 - 1040°F for 1 hour per inch of thickness, 2 hours minimum at temperature. Water quench after stress relief.

### **Weld blending and inspection:**

The weld is to be ground flush with the adjacent parent material. The weld is to be inspected by magnetic particle to verify that the weld area is free of all crack indications.