

PETOL™ BUKUP TONG™ - BA120 Parts List

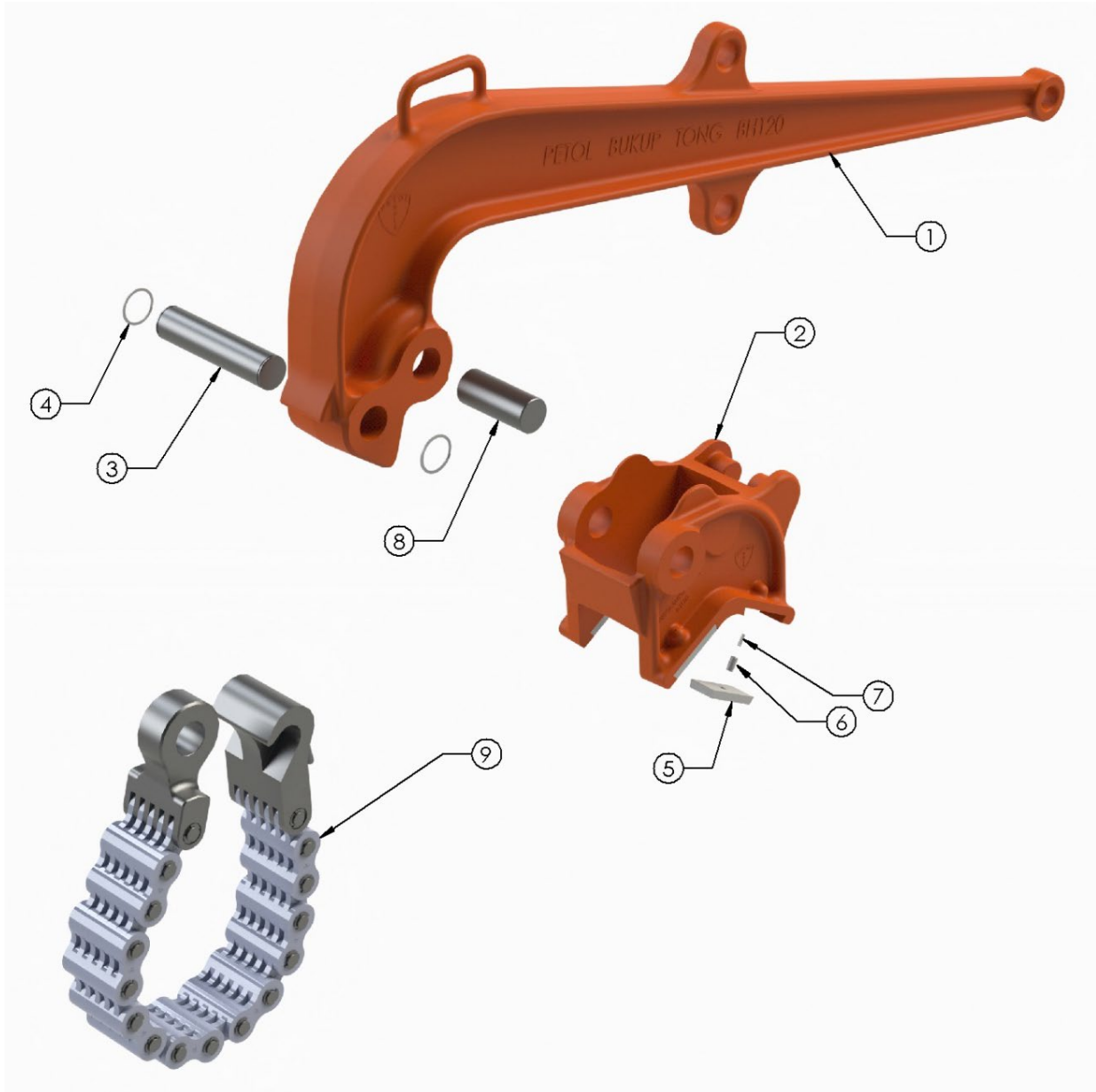

Item	Qty.	Part Number	Description
1	1	BH120	Handle
2	1	BJ120	Jaw
3	1	HP019	Jaw-handle pin with retaining ring
4	1	HXRR250	Jaw-handle retaining ring only
5	4	HI10D	Diamond point insert
6	4	HP904	Insert key
7	4	HS21	Insert key spring
8	1	HP020	Master link – handle pin
9	1	*	Chain assembly (see next page for parts)

*See Chain Guide on product web page



4450 S. Hwy. 6 | P.O. Box 192
Clifton, TX 76634 | USA
www.PETOL.com

sales@petol.com | 254.675.8651

PETOL™ BUKUP TONG™ - BA120 Parts List

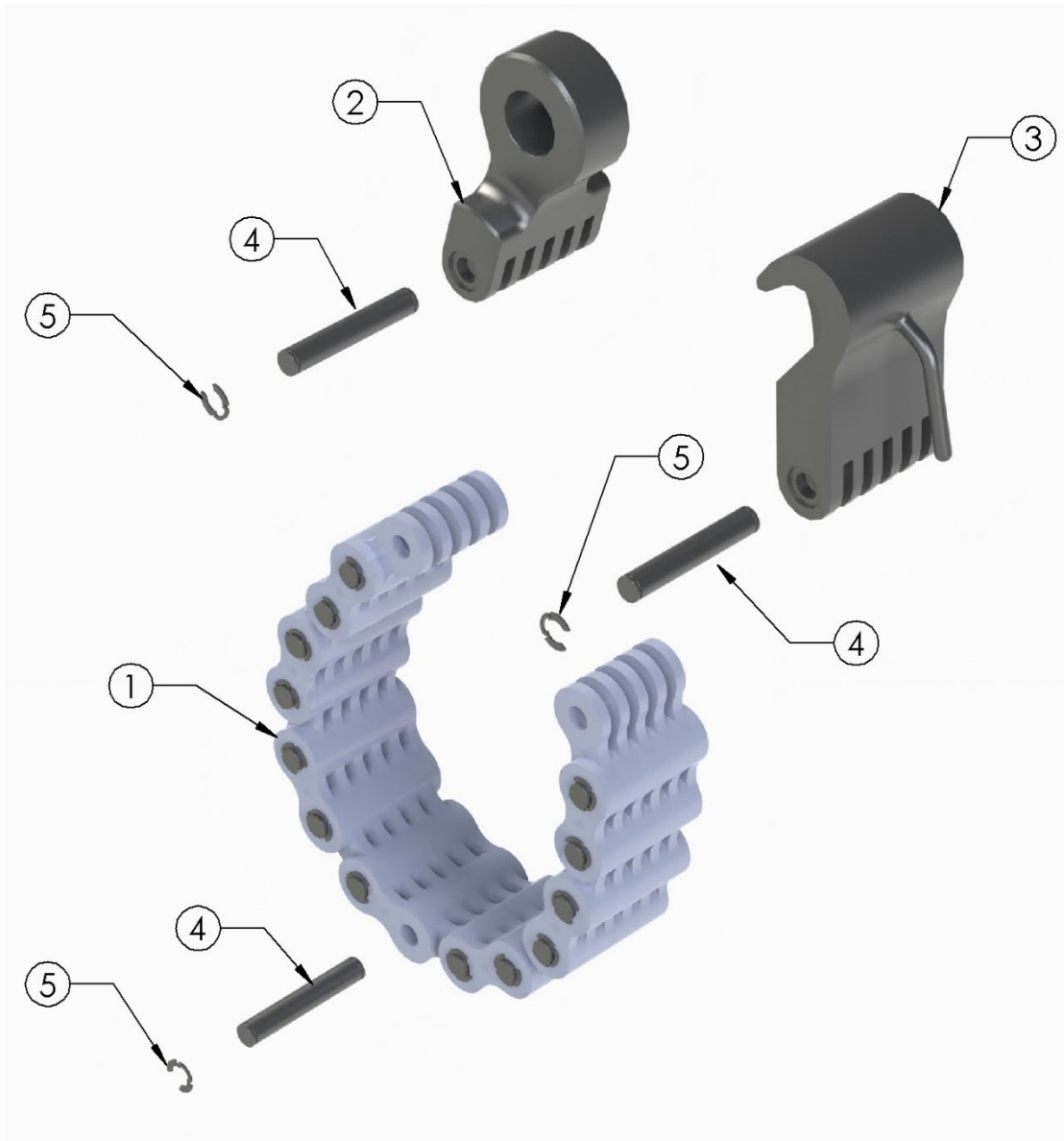

Item	Part No.	Description
1	201-56-02	Special chain only
1	201-56-03	Special chain only
1	201-56-05	Special chain only
1	201-56-07	Special chain only
2	HM09-56	Master link
3	HC07-56-6000	Chain hook
3	HC07-56-7750	Chain hook
3	HC07-56-9875	Chain hook
4	HP328	Chain pin with kliplings
5	HXKR100	Chain pin klipling only



4450 S. Hwy. 6 | P.O. Box 192
 Clifton, TX 76634 | USA
www.PETOL.com

sales@petol.com | 254.675.8651