

# PETOL™ TONGVISE – TVA115H Parts List

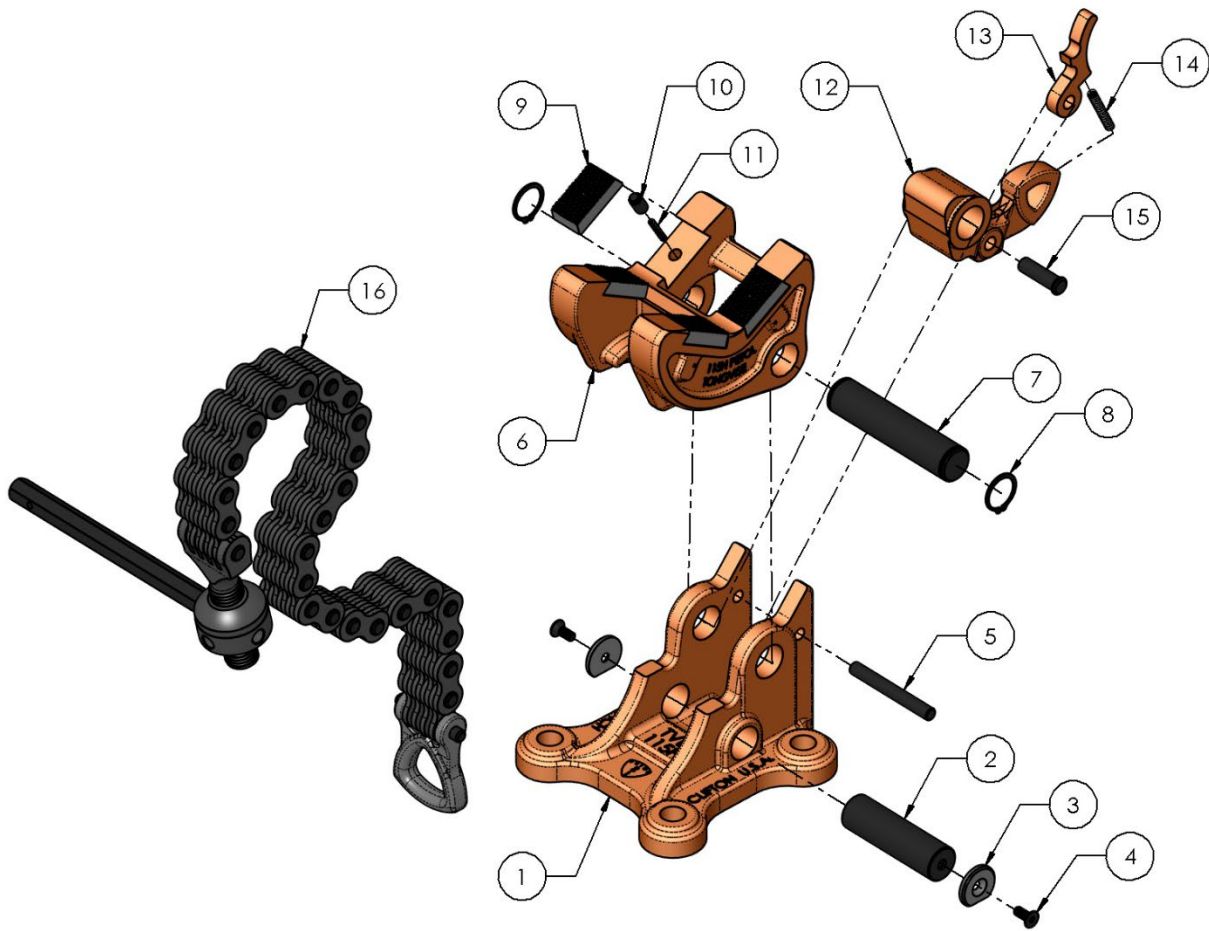

Item	Qty.	Part Number	Description
1	1	TVB115H	Base
2	1	HP274	Base lock pin
3	2	HP274-RP	Lock pin retaining plate
4	2	HXS090	Retaining plate screw
5	1	HP297	Pawl latch pin
6	1	TVJ115H	Jaw
7	1	HP292	Base – jaw pin with retaining rings
8	2	HXR125	Jaw pin retaining ring only
9	4	HI04D	Diamond point insert (standard)
9		HI04K	Knurled insert (optional)
10	4	HP903	Insert key
11	4	HS20S	Insert key spring
12	1	TVP115	Pawl
13	1	TVL116	Pawl latch
14	1	HS25	Pawl latch spring
15	1	HP026	Pawl latch rivet
16	1	151-45-25T	Chain assembly (see next page for parts)



4450 S. Hwy. 6 | P.O. Box 192  
 Clifton, TX 76634 | USA  
[www.PETOL.com](http://www.PETOL.com)

[sales@petol.com](mailto:sales@petol.com) | 254.675.8651

# PETOL™ TONGVISE – TVA115H Parts List

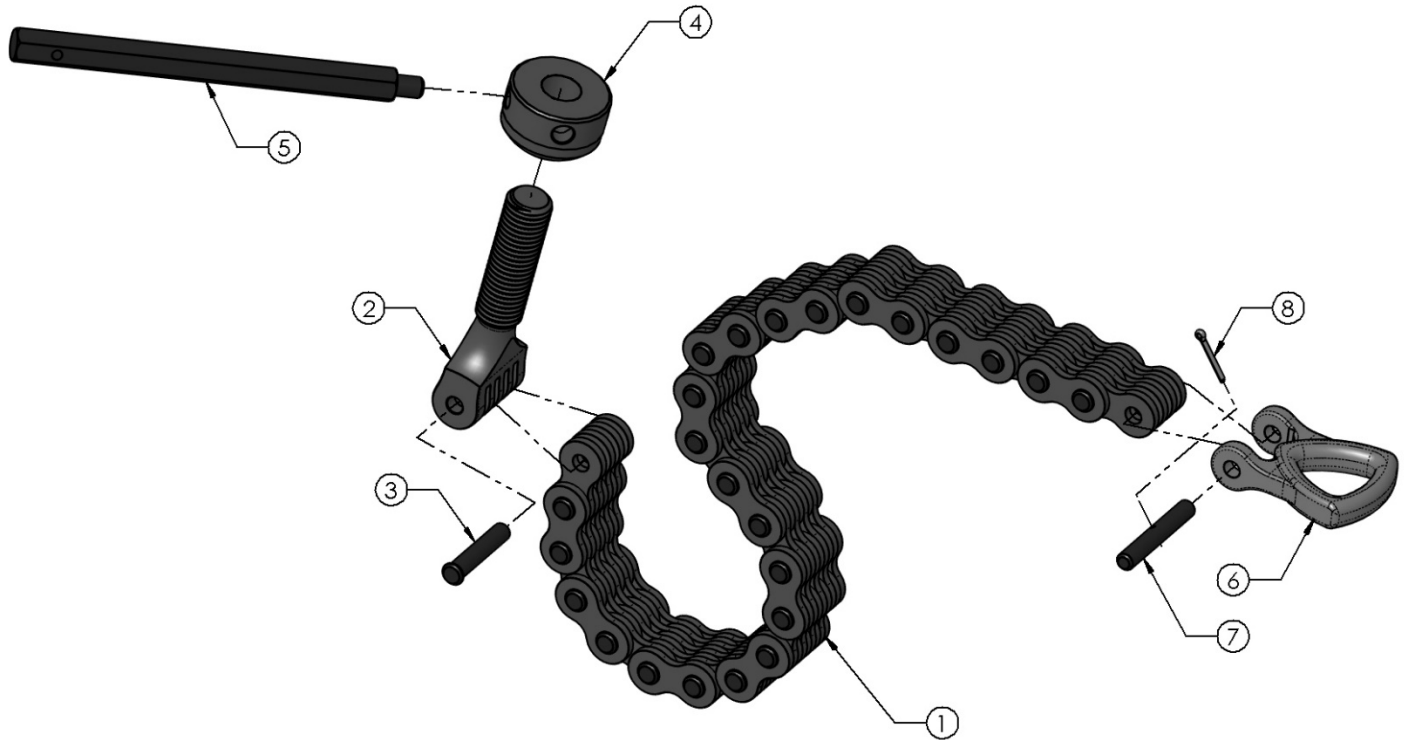

Item	Part No.	Description
1	151-45-25	Special chain only
2	HV07-45	Chain screw
3	HP236	Chain screw rivet
4	HN05	Chain screw nut
5	HP951	Chain nut lever
6	HD2-45	Chain handle
7	HP280	Chain handle pin with cotter
8	HXC002	Chain handle pin cotter only



4450 S. Hwy. 6 | P.O. Box 192  
 Clifton, TX 76634 | USA  
[www.PETOL.com](http://www.PETOL.com)

[sales@petol.com](mailto:sales@petol.com) | 254.675.8651